

Product 713-763: Plug screw connection PG 9
Area M12-A

Article number 08 3128 000 000

Date: 2015-06-04 - Page 1 of 1

Illustration



Scale drawing

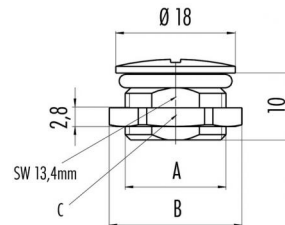

A	B	C
PG 9	Ø 20	SW 18mm
M16x1,5	Ø 21	SW 19mm

Matching products

- Male panel mount connector, fixing thread, PG 9, M16 x 1.5
- Male panel mount connector, screwed from front, dip-soldered, PG 9
- Male panel mount connector, screwed from front, with shielding sheet, dip-soldered, PG 9
- Male panel mount connector, PG 9, screwed from front, with shielded PUR cable
- Female panel mount connector, solder, PG 9, M16 x 1.5
- Female panel mount connector, screwed from front, dip-solder, PG 9, 6 mm contact length
- Female panel mount connector, PG 9, screwed from front, with shielded PUR cable
- Male panel mount connector, POWER, with single wires, AWG 18, PG 9, UL approval
- Female panel mount connector, POWER, with single wires, AWG 18, PG 9, UL approval