

Product 713-825: Hexagonal nut for fixing thread, M20x1.5
Area M12-B

Article number 16 0917 001

Illustration



Scale drawing

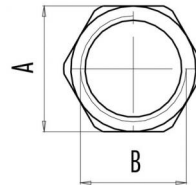

Gewinde B Thread B	Schlüsselweite A Wrench size A
PG 9	SW18 mm
PG 11	SW21 mm
PG 13,5	SW23 mm
M16 x 1,5	SW19 mm
M20 x 1,5	SW24 mm

Matching products

Male panel mount connector, fixing thread, PG 13.5, M20 x 1.5