

Product **Contacts: 5, Male panel mount connector, rectangular flange, solder**  
 Area **M16 IP67 Series 423/ 723/ 425**  
 Article number **09 0115 300 05**

### Illustration

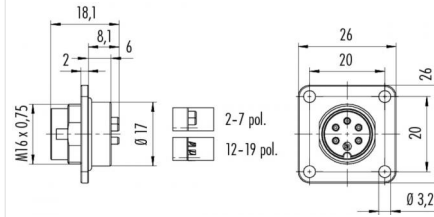

### Scale drawing



### Contact Arrangement

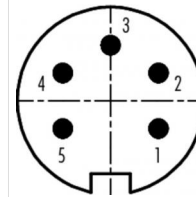

	X	Y
1	3,03	-1,75
2	3,03	1,75
3	0,00	3,50
4	-3,03	1,75
5	-3,03	-1,75

**You can find the assembly instruction on the next page.**

## Technical data

### General features

Connector Design male panel mount connector  
 Connector locking system bolted  
 Termination solder  
 Wire gauge (mm) 0,75 mm<sup>2</sup>  
 Wire gauge (AWG) 20  
 Upper temperature 95 °C  
 Lower temperature -40 °C

### Electrical parameters

Rated voltage 250 V  
 Rated impulse voltage 1500 V  
 Pollution degree 1  
 Overvoltage category I  
 Material group III  
 Rated current (40°C) 6 A  
 Volume resistivity ≤ 5 mΩ  
 Degree of protection IP67  
 Mechanical operation > 500 Mating cycles

### Material

Material of contact CuZn (Messing)  
 Contact plating Ag (silver)  
 Material of contact body PBT (UL 94 V-0)

Product **Contacts: 5, Male panel mount connector, rectangular flange, solder**

Area **M16 IP67 Series 423/ 723/ 425**  
Article number **09 0115 300 05**

Installation instructions / Mounting cutout

