

Product	Contacts: 4, Square male panel mount connector, adjustable, Optimal contact plating, IP 40, with seal IP 67 (see accessories)	Area Article number	M12-A Series 713/763 09 0431 16 04
Pole	4		

Illustration	Scale drawing	Contact Arrangement															
		<table border="1"> <thead> <tr> <th></th> <th>X</th> <th>Y</th> </tr> </thead> <tbody> <tr> <td>1</td> <td>2,50</td> <td>0,00</td> </tr> <tr> <td>2</td> <td>0,00</td> <td>2,50</td> </tr> <tr> <td>3</td> <td>-2,50</td> <td>0,00</td> </tr> <tr> <td>4</td> <td>0,00</td> <td>-2,50</td> </tr> </tbody> </table>		X	Y	1	2,50	0,00	2	0,00	2,50	3	-2,50	0,00	4	0,00	-2,50
	X	Y															
1	2,50	0,00															
2	0,00	2,50															
3	-2,50	0,00															
4	0,00	-2,50															

You can find the assembly instruction on the next page.

Technical data

Common values

Connector Design	Male panel mount connector
Connector locking system	screw
Termination	Solder
Wire gauge (mm)	0.25 mm ²
Wire gauge (AWG)	24
Upper temperature	85 °C
Lower temperature	-40 °C

Electrical values

Rated voltage	250 V
Rated impulse voltage	2500 V
Pollution degree	3
Overvoltage category	II
Material group	II
Rated current (40°C)	4 A
Volume resistivity	≤ 8 mΩ
EMV compliance	nicht geschirmt
Degree of protection	IP67
Mechanical operation	> 50 mating cycles

Material

Material of contact	CuZn (Brass)
Contact plating	CuSnZn (Optaloy)
Material of contact body	PBT
Material of housing	PA

Contacts: 4, Square male panel mount connector, adjustable, Optimal contact plating, IP 40, with seal IP 67 (see accessories)

Product

Contacts: 4, Square male panel mount connector, adjustable, Optimal contact plating, IP 40, with seal IP 67 (see accessories)

Area
Article number

**M12-A Series 713/763
09 0431 16 04**

Pole

4

Installation instructions / Mounting cutout

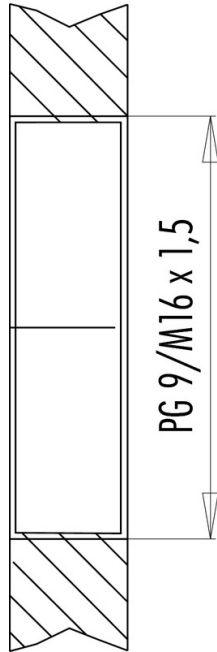

Anzugsdrehmoment / *Tightening moment*
6,25 Nm