

Product **Polzahl 8: Einbaustecker, SMT, mit Gehäuse, schirmbar, Einbauhöhe 9mm**

Area **M12-A Series 713/763**
Article number **99 3481 401 08**

Illustration



Scale drawing

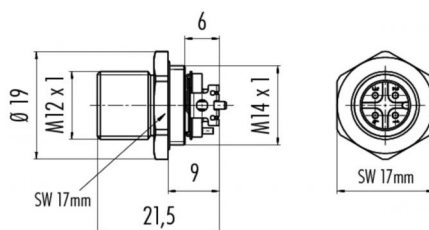

Contact Arrangement

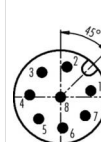

| | X | Y |
|---|-------|-------|
| 1 | 2,69 | 0,57 |
| 2 | 0,57 | 2,69 |
| 3 | -1,66 | 2,20 |
| 4 | -2,75 | 0,19 |
| 5 | -1,94 | -1,94 |
| 6 | 0,19 | -2,74 |
| 7 | 2,20 | -1,65 |
| 8 | 0,00 | 0,00 |

- 1 weiß/white
- 2 braun/brown
- 3 grün/green
- 4 gelb/yellow
- 5 grau/grey
- 6 rosa/pink
- 7 blau/blue
- 8 rot/red

Geschirmte Versionen: Schirm auf Gehäuse oder Pin 8
Shielded versions: shield on housing or pin 8

You can find the assembly instruction on the next page.

Technical data

General features

| | |
|--------------------------|-----------------|
| Connector Design | integrated plug |
| Connector locking system | bolted |
| Termination | dip-solder |
| Upper temperature | 85 °C |
| Lower temperature | -40 °C |

Electrical parameters

| | |
|-----------------------|--------------------|
| Rated voltage | 30 V |
| Rated impulse voltage | 800 V |
| Pollution degree | 3 |
| Overvoltage category | II |
| Material group | III |
| Rated current (40°C) | 1,5 A |
| Volume resistivity | ≤ 3 mΩ |
| EMV compliance | shieldable |
| Degree of protection | IP67 |
| Mechanical operation | > 50 Mating cycles |

Material

| | |
|--------------------------|----------------|
| Material of contact | CuZn (Messing) |
| Contact plating | Au (gold) |
| Material of contact body | LCP |

Product **Polzahl 8: Einbaustecker, SMT, mit Gehäuse, schirmbar, Einbauhöhe 9mm**
Area **M12-A Series 713/763**
Article number **99 3481 401 08**

Installation instructions / Mounting cutout

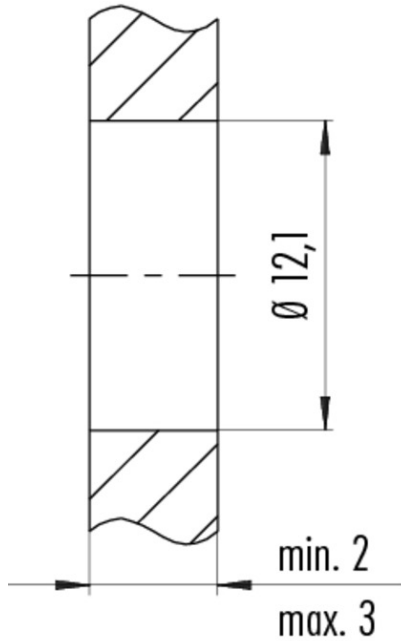

Anzugsdrehmoment / *Tightening moment*
M12 x 1 6,25 Nm