

Product **Polzahl 8: Einbaustecker, SMT, mit Gehäuse, Einbauhöhe 9mm**  
 Area **M12-A Series 713/763**  
 Article number **99 3481 351 08**

Illustration	Scale drawing	Contact Arrangement																																				
		<table border="1" style="margin: 10px auto;"> <thead> <tr> <th></th> <th>X</th> <th>Y</th> <th></th> </tr> </thead> <tbody> <tr><td>1</td><td>2,69</td><td>0,57</td><td>1 weiß/white</td></tr> <tr><td>2</td><td>0,57</td><td>2,69</td><td>2 braun/brown</td></tr> <tr><td>3</td><td>-1,66</td><td>2,20</td><td>3 grün/green</td></tr> <tr><td>4</td><td>-2,75</td><td>0,19</td><td>4 gelb/yellow</td></tr> <tr><td>5</td><td>-1,94</td><td>-1,94</td><td>5 grau/grey</td></tr> <tr><td>6</td><td>0,19</td><td>-2,74</td><td>6 rosa/pink</td></tr> <tr><td>7</td><td>2,20</td><td>-1,65</td><td>7 blau/blue</td></tr> <tr><td>8</td><td>0,00</td><td>0,00</td><td>8 rot/red</td></tr> </tbody> </table> <p style="font-size: small;">Geschirmte Versionen: Schirm auf Gehäuse oder Pin 8                      Shielded versions: shield on housing or pin 8</p>		X	Y		1	2,69	0,57	1 weiß/white	2	0,57	2,69	2 braun/brown	3	-1,66	2,20	3 grün/green	4	-2,75	0,19	4 gelb/yellow	5	-1,94	-1,94	5 grau/grey	6	0,19	-2,74	6 rosa/pink	7	2,20	-1,65	7 blau/blue	8	0,00	0,00	8 rot/red
	X	Y																																				
1	2,69	0,57	1 weiß/white																																			
2	0,57	2,69	2 braun/brown																																			
3	-1,66	2,20	3 grün/green																																			
4	-2,75	0,19	4 gelb/yellow																																			
5	-1,94	-1,94	5 grau/grey																																			
6	0,19	-2,74	6 rosa/pink																																			
7	2,20	-1,65	7 blau/blue																																			
8	0,00	0,00	8 rot/red																																			

**You can find the assembly instruction on the next page.**

## Technical data

### General features

Connector Design	integrated plug
Connector locking system	bolted
Termination	dip-solder
Upper temperature	85 °C
Lower temperature	-40 °C

### Electrical parameters

Rated voltage	30 V
Rated impulse voltage	800 V
Pollution degree	3
Overvoltage category	II
Material group	III
Rated current (40°C)	1,5 A
Volume resistivity	≤ 3 mΩ
EMV compliance	shieldable
Degree of protection	IP67
Mechanical operation	> 50 Mating cycles

### Material

Material of contact	CuZn (Messing)
Contact plating	Au (gold)
Material of contact body	LCP

Product **Polzahl 8: Einbaustecker, SMT, mit Gehäuse, Einbauhöhe 9mm**  
Area **M12-A Series 713/763**  
Article number **99 3481 351 08**

Installation instructions / Mounting cutout

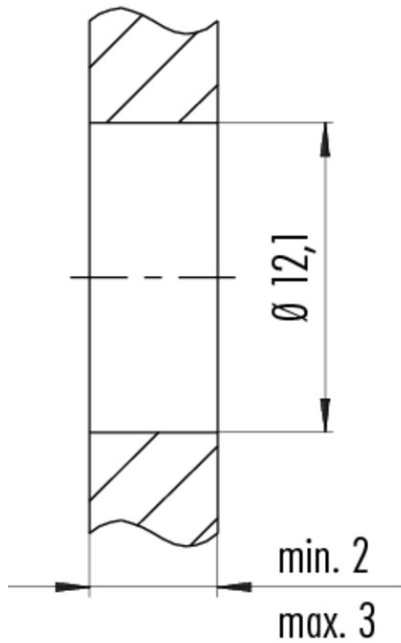

Anzugsdrehmoment / *Tightening moment*  
M12 x 1      6,25 Nm